

MS Cyrano de Bergerac

5 anchors - Gironde, Garonne, Dordogne - 87 cabins



MS Cyrano de Bergerac

The MS Cyrano de Bergerac cruises along the Gironde, Garonne and Dordogne.

Interior design



Cabins

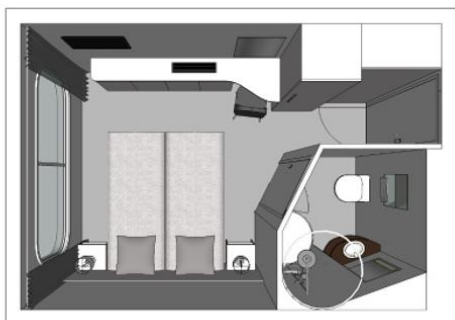

- Middle Deck 1 double bed 8 m²
- Middle Deck 2 beds - people with reduced mobility 13 m²
- Middle deck 2 adjustable twin beds 13 m²
- Main Deck 1 double bed 8 m²
- Main deck 2 adjustable twin beds 13 m²
- Upper Deck 1 double bed 8 m²
- Upper deck 2 adjustable twin beds 13 m²

Cabins equipments

- TV
- Telephone (for internal calls only)
- Bathroom with shower and toilet
- Towels
- Safe
- Independent air-conditioning
- Electricity 220V
- Wi-Fi

Please note that there is no laundry service on board the ship.

Decks and technical details

MAIN DECK 25 cabins

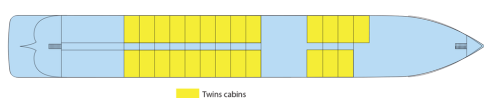

MIDDLE DECK 21 cabins



UPPER DECK 41 cabins

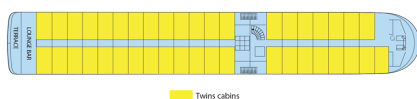

Number of cabin decks : 3
Number of cabins : 87
Width : 11.40
Year Built : 2013
Guest capacity : 174
Length : 110
Number of crew members : 25
Elevators
Cabin for Mobility Impaired
Cabins outside

SUN DECK

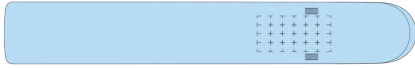

MIDDLE DECK : RESTAURANT - RECEPTION DESK - LOUNGE BAR WITH DANCEFLOOR

UPPER DECK : PIANORAMABAR - TERRACE

SUN DECK : FITNESS - SUN DECK